

**MICRO SWITCH**  
a Honeywell Division

FED. MFG. CODE 91929

SWITCH-BASIC

CATALOG LISTING

V7-7H15D8-263-1

CW-C6210

CATALOG LISTING  
V7-7H15D8-263-1

ISSUE

**M**

7

REPLACES X88608-V7

RELEASE NO. PR-16571

CHECK

REVISIONS

A	CORR	WJM	20 MAY 88
B	CORR	WJM	10 JUN 88
C	PR-16571	KAG	15 JUL 88
D	CO66350	JAP	21 SEP 89
E	CO-69205	BAB	7 JAN 91
F	CO-76215	LJF	11 NOV 93

CHECK

JAP 17 MAY 88

CHECK

WJM 17 MAY 88

DDM/CAD  
DRAWN

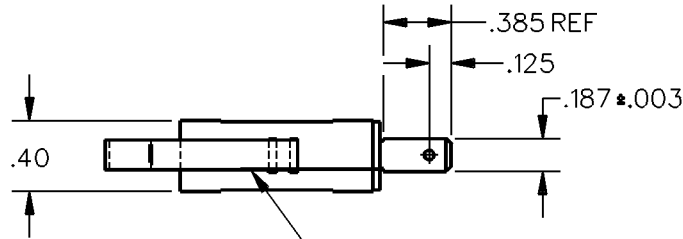

CORROSION RESISTANT  
STEEL ACTUATOR

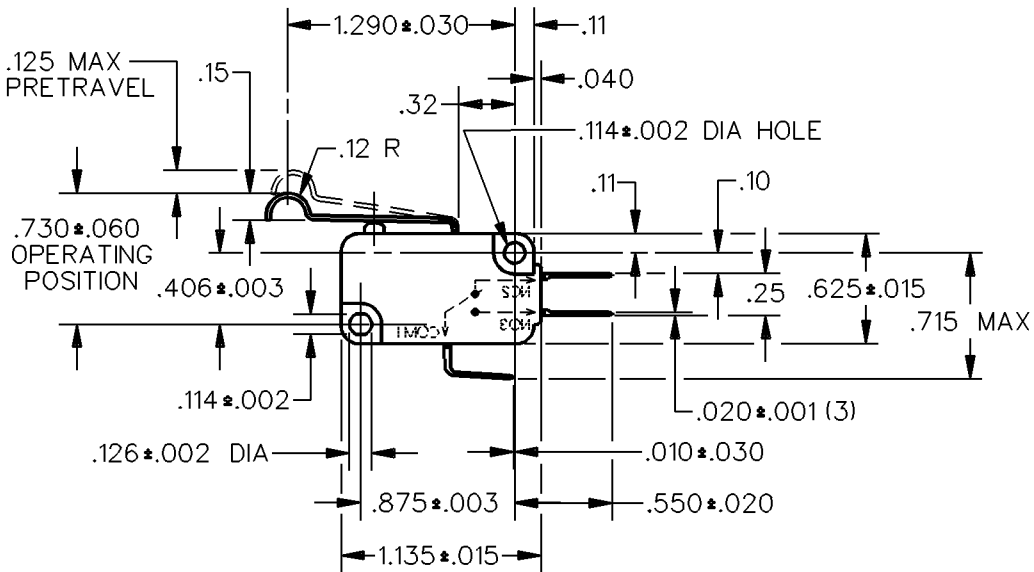

NOTES

- 1 - SERRATED STATIONARY CONTACTS
- 2 - MARK CATALOG LISTING AND DATE CODE ONLY ON SWITCH

THIS DRAWING COVERS A PROPRIETARY ITEM AND IS THE PROPERTY OF MICRO SWITCH, A DIVISION OF HONEYWELL. THIS DRAWING IS NOT TO BE COPIED OR USED WITHOUT THE APPROVAL OF MICRO SWITCH.

THIRD ANGLE PROJECTION

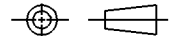

CHARACTERISTICS

OPERATING FORCE-----4 OZ MAX  
RELEASE FORCE-----1/2 OZ MIN  
RELEASE TRAVEL-----.015 MIN  
DIFFERENTIAL TRAVEL-----.050 MAX  
OVERTRAVEL-----.080 MIN

ELECTRICAL DATA

CONTACT ARRANGEMENT  
S P D T

SCALE FULL

DO NOT  
SCALE PRINT

**UNLESS OTHERWISE SPECIFIED  
TOLERANCES ARE**

ONE PLACE (.0) ±.030

TWO PLACE (.00) ±.015

THREE PLACE (.000) ±.005

ANGLES ±

WEIGHT